

NOTES:

1. 1/32" LIP AROUND PIPE FOR WELDING FIT
DIAMETER CLAEARANCE .030 AT MMM, .003 AT LMC.
2. ALL MATERIAL 304 STAINLESS: 2" SCH. 40 PIPE & 1/4" PLATE.
3. BOLTING PATTERN MEETS E-62 FIGURE E11E FROM AAR.
4. ANSI B2.1 2" NPT PIPE THREAD.
5. FLATNESS TO BE +OR- 1/32".
6. THIS ASSEMBLY IS DESIGNED FOR PRESSURES OF NO GREATER THAN 30 P.S.I.
7. MUST PASS QAP4C-1.
8. WELD MUST BE IN ACCORDANCE WITH AWS D15.1 (OR APPROVED EQUIVALENT) BY CERTIFIED WELDERS. PROCEDURES ARE TO BE VENDOR SUPPLIED AND SALCO APPROVED.

REV	BY	DATE	DESCRIPTION
J	RJP	8/19/15	ADDED SHEET 2 WITH PDFPT550F & N2CS6 FABRICATION, UPDATED TITLE BLOCK
I	REH	12/2/10	REMOVED Ø3.13 INSERT, UPDATED NOTES
H	BRG	10/12/07	UPDATED DRAWING
G	MRC	1/29/99	ADDED FLATNESS NOTE, ADDED FINSH NOTE, REMOVE WELDING NOTE
F	MRC	12/10/98	FLANGE RADIUS WAS 1.260. ADDED TOL TO PIPE RADIUS
E	MRC	11/6/98	CHANGED 5.50 DIM. FROM RADIUS TO DIAMETER
D	MRC	10/15/97	NOTE WAS LABLED SCHEDULE 80
C	CLH	6/9/97	ADDED PART NO. NOTE
B	CLH	1/21/97	DIM. 2.50" TO 1.50"
A	CLH	12/13/96	PART NO. SVFA550F TO PDSVFA550F. NEW BORDER

UNLESS OTHERWISE SPECIFIED DIMENSIONAL TOLERANCES FRACTIONAL: ±1/16 X.XX: ±.03 X.XXX: ±.015 ANGLE: ±1° DEBURR ALL SHARP EDGES. ALL MACHINED SURFACES TO HAVE A 125 RMS FINISH UNLESS NOTED OTHERWISE.	DRAWN BY:	BJC
	CHECKED BY:	AVD
	PROTOTYPE BY:	BJC
	PROTOTYPE DATE:	9/6/1994
THIRD ANGLE PROJECTION	APPROVED FOR PRODUCTION BY:	AVD
	PRODUCTION DATE:	9/6/1994

SALCO PRODUCTS, INC.

PART NAME: **QUICK INSPECT ADAPTER FLANGE**

MATERIAL: **SEE NOTE**

PROJECT #: SHEET #: **1 OF 2** SCALE: **1:1**

DRAWING #: **C5948** PART #: **PDFPT550M**

NO.	PART NAME	PART #	REQ'D	MATERIAL
1	QUICK INSPECT ADAPTER FLANGE	PDFPT550F	1	304 SS
2	PIPE NIPPLE 2"	N2CS6	1	316 SS

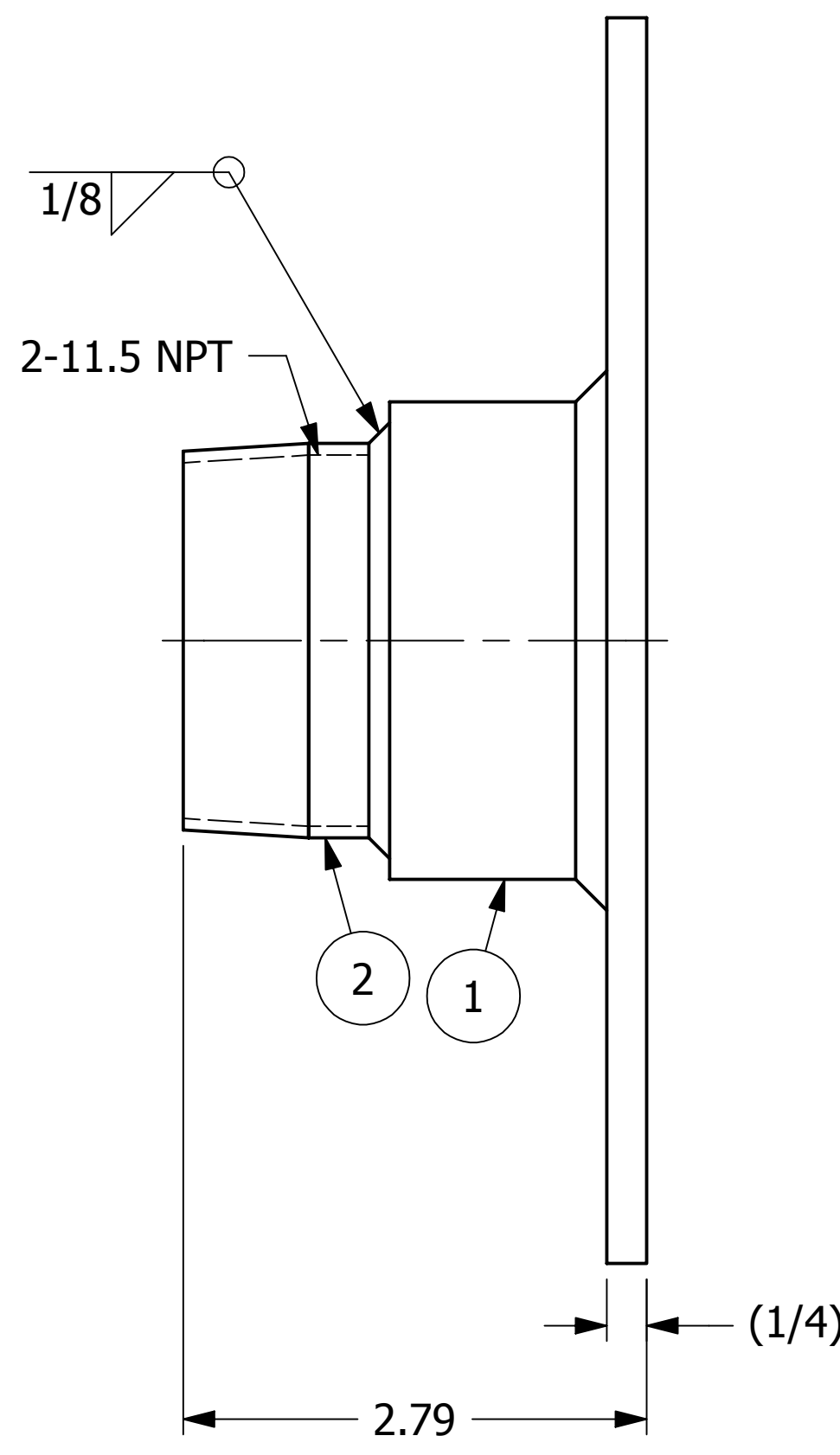
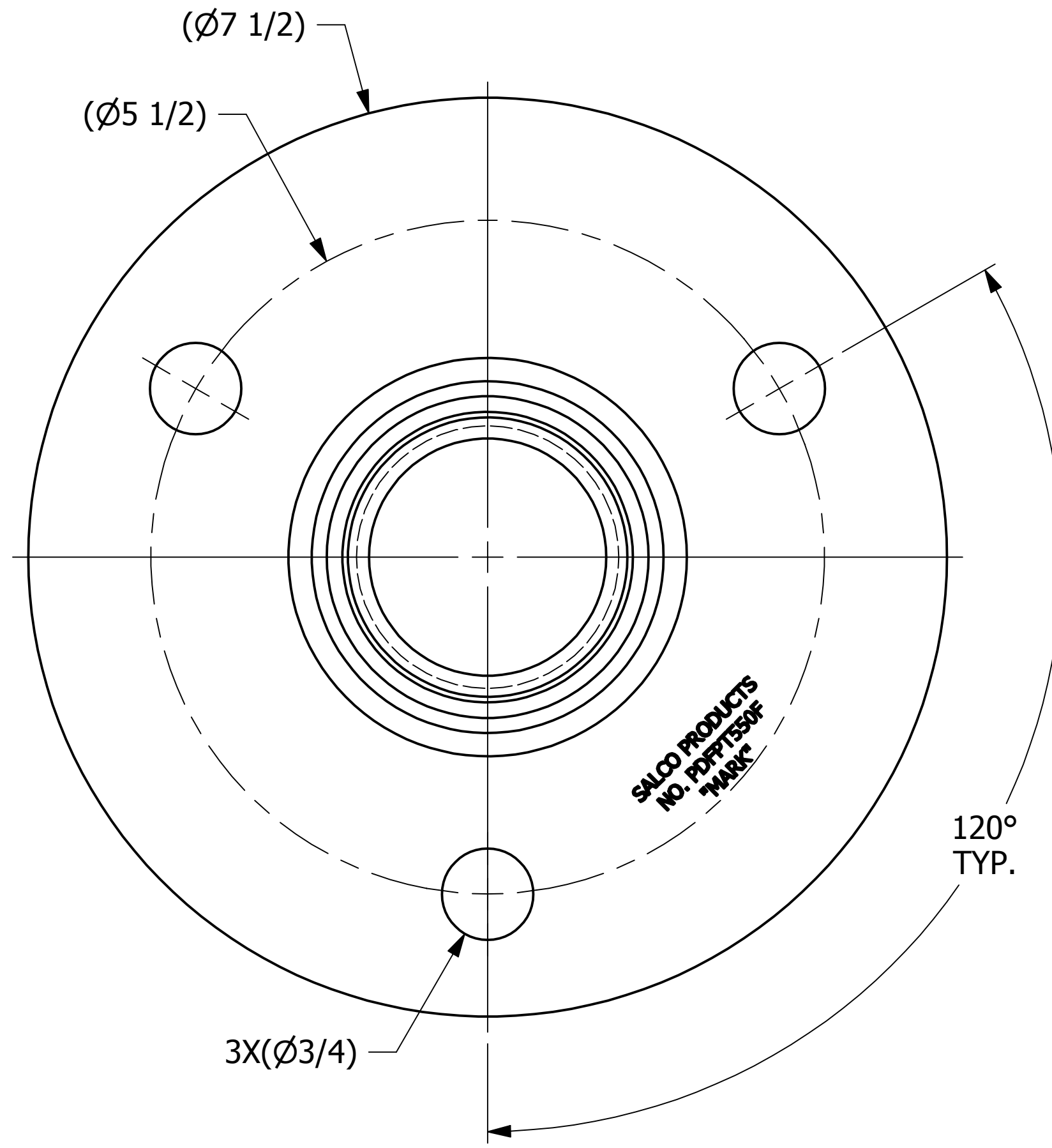

REV	BY	DATE	DESCRIPTION
J	RJP	8/19/15	ADDED SHEET 2 WITH PDFPT550F & N2CS6 FABRICATION, UPDATED TITLE BLOCK
I	REH	12/2/10	REMOVED Ø3.13 INSERT, UPDATED NOTES
H	BRG	10/12/07	UPDATED DRAWING
G	MR C	1/29/99	ADDED FLATNESS NOTE, ADDED FINSH NOTE, REMOVE WELDING NOTE
F	MR C	12/10/98	FLANGE RADIUS WAS 1.260. ADDED TOL TO PIPE RADIUS
E	MR C	11/6/98	CHANGED 5.50 DIM. FROM RADIUS TO DIAMETER
D	MR C	10/15/97	NOTE WAS LABELED SCHEDULE 80
C	CLH	6/9/97	ADDED PART NO. NOTE
B	CLH	1/21/97	DIM. 2.50" TO 1.50"
A	CLH	12/13/96	PART NO. SVFA550F TO PDSVFA550F. NEW BORDER

NOTE:
WELD MUST BE IN ACCORDANCE WITH AWS D15.1
(OR APPROVED EQUIVALENT) BY CERTIFIED WELDERS.
PROCEDURES ARE TO BE VENDOR SUPPLIED AND SALCO
APPROVED.

UNLESS OTHERWISE SPECIFIED DIMENSIONAL TOLERANCES FRACTIONAL: ±1/16 X.XX: ±.03 X.XXX: ±.015 ANGLE: ±1° DEBURR ALL SHARP EDGES. ALL MACHINED SURFACES TO HAVE A 125 RMS FINISH UNLESS NOTED OTHERWISE. THIRD ANGLE PROJECTION	DRAWN BY:	BJC
	CHECKED BY:	AVD
	PROTOTYPE BY:	BJC
	PROTOTYPE DATE:	9/6/1994
	APPROVED FOR PRODUCTION BY:	AVD
	PRODUCTION DATE:	9/6/1994

SALCO PRODUCTS, INC.

PART NAME: **QUICK INSPECT ADAPTER FLANGE**

MATERIAL: **SEE NOTE**

PROJECT #: SHEET #: **2 OF 2** SCALE: **1:1**

DRAWING #: **C5948** PART #: **PDFPT550M**