

NO.	PART NAME	PART #	REQ'	MATERIAL
1	HATCH COVER LATCH END 20"	LEC20U	1	ALUMINUM
2	HATCH COVER ARM 20"	P20SAPS3	1	304 SS
3	BUMPER	VAB	1	EPDM
4	HEX BOLT 1/2"-13 X 5"	HB203P	1	304 SS
5	HEX LOCK NUT 5/16"-18	R20ANS	1	18-8 SS
6	HEX BOLT 5/16"-18X1 1/4"	R20ABS	1	18-8 SS
7	HEX LOCK NUT 1/2"-13	TN20LN	1	CS Z/P

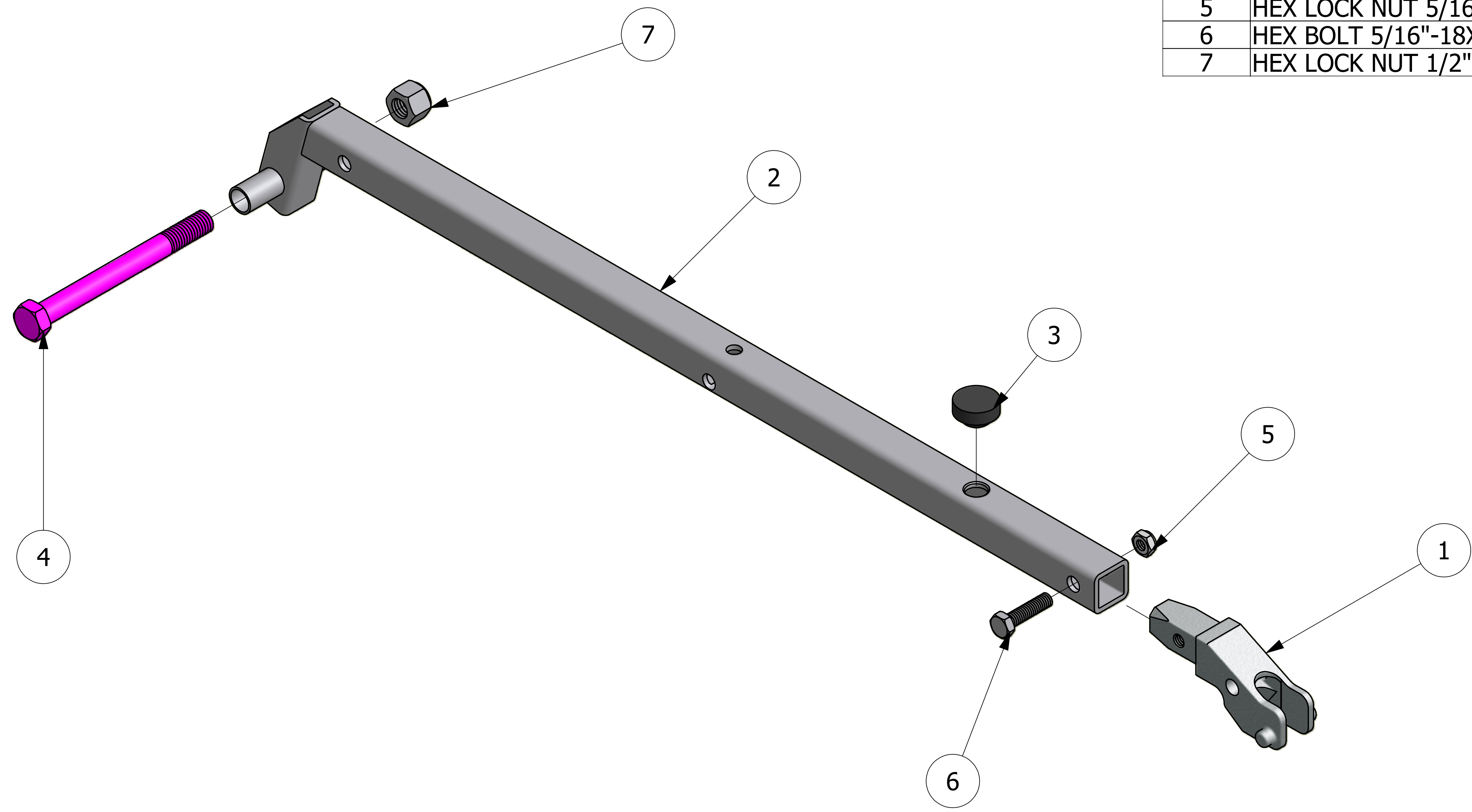

C	REH	02-18-10	UPDATED DRAWING & ADDED BOM
B	CHL	10-24-02	REMOVED HCN20S & HCB20S FROM ASSEMBY
A	MRC	08-09-99	REPLACED LEC20U TO REFLECT PROPER VIEW ADDED 11/32" DIA. HOLE TO ARM
REV	BY	DATE	DESCRIPTION

UNLESS OTHERWISE SPECIFIED DIMENSIONAL TOLERANCES FRACTIONAL: ±1/16 X.XX: ±.015 X.XXX: ±.005 ANGULAR: ±1° DEBURR ALL SHARP EDGES. ALL MACHINED SURFACES TO HAVE A 125 RMS FINISH UNLESS NOTED OTHERWISE. THIRD ANGLE PROJECTION	DRAWN BY:	FOD
	CHECKED BY:	SAB
	PROTOTYPE BY:	FOD
	PROTOTYPE DATE:	
	APPROVED FOR PRODUCTION BY:	
	PRODUCTION DATE:	

SALCO PRODUCTS, INC.

PART NAME: **ARM ASSEMBLY COVER 20"**

MATERIAL: **SEE BOM**

PROJECT #: **1 OF 1** SCALE: **3:4**

DRAWING #: **D9449** PART #: **P203SCA**

THIS PRINT, PROPERTY OF SALCO PRODUCTS INC. CONTAINS PROPRIETARY INFORMATION AND MUST NOT BE COPIED, REPRODUCED, OR USED DETRIMENTALLY TO OUR INTEREST.