

NO.	PART NAME	PART #	REQ'D	MATERIAL
1	QUICK CONNECT ADAPTER 4" FLANGED	TE4SFW	1	316SS
2	FLANGE GASKET 3"	TE3FG	1	BLACK NITRILE

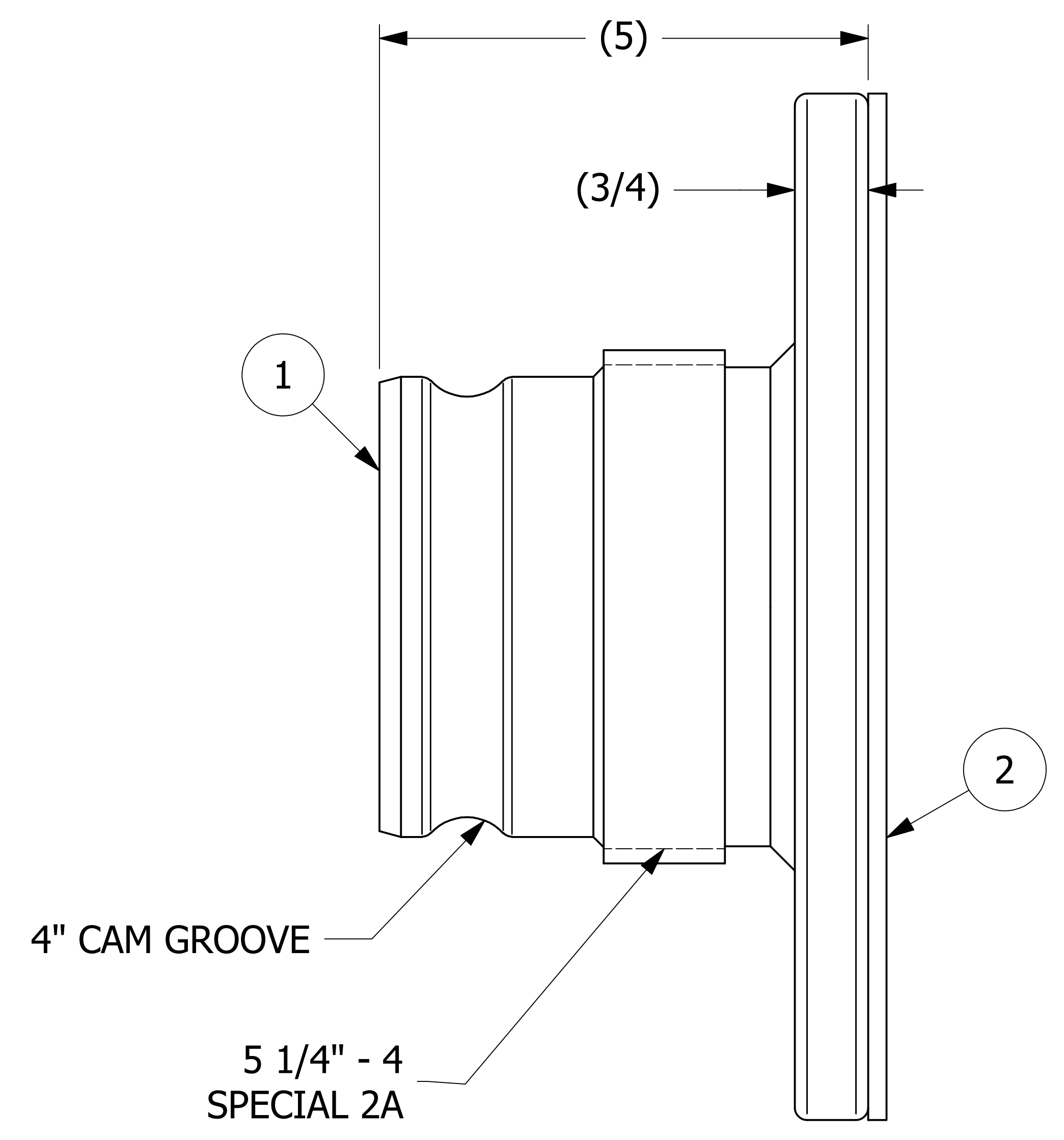
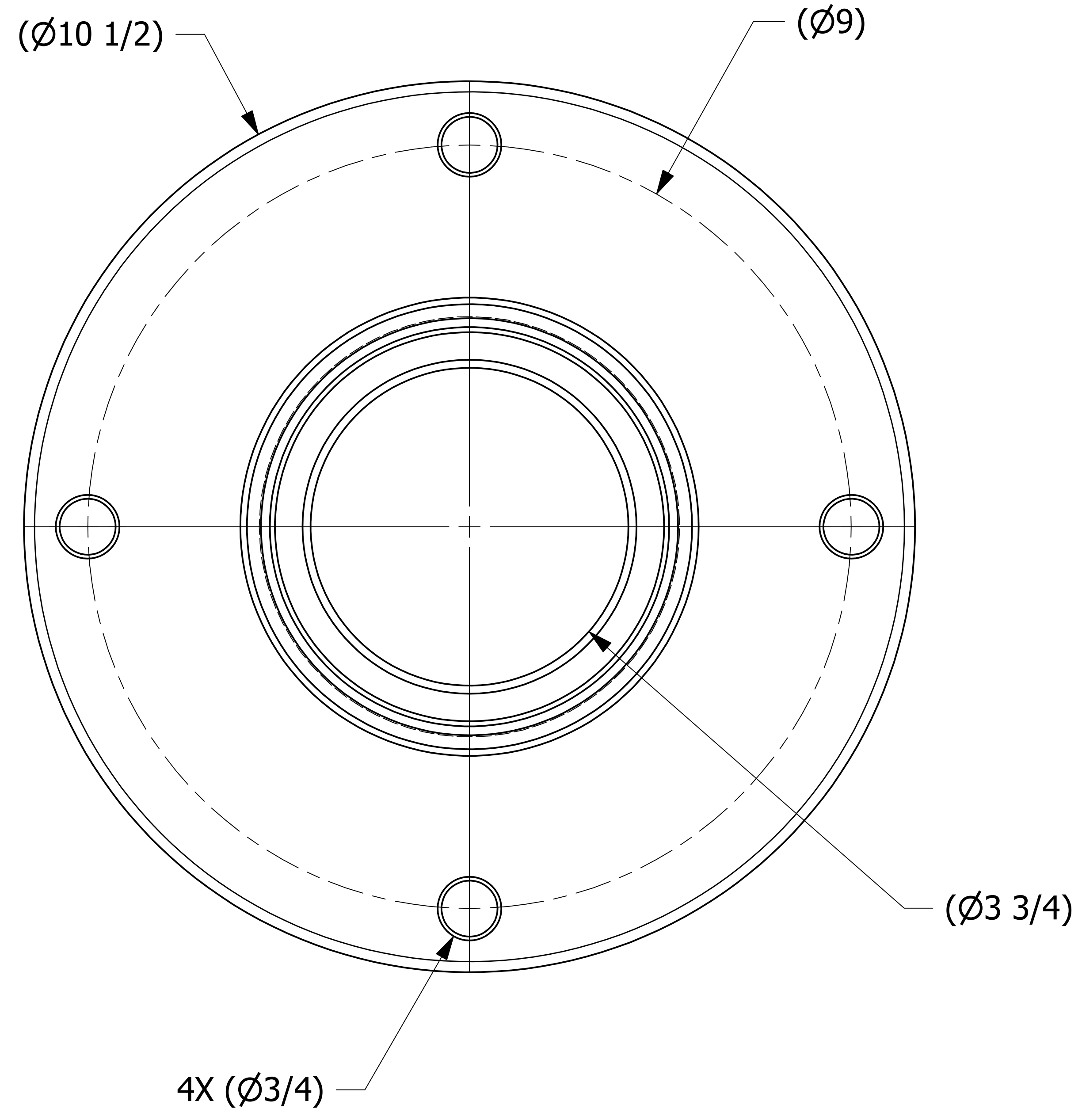

- NOTES:**
1. THIS ASSEMBLY IS AAR AND DOT APPROVED.
  2. AAR APPROVAL # E-149523.
  3. QUICK DISCONNECT MEETS A-A-59326D.
  4. ADAPTER THREADS PER FIGURE E-18 IN THE AAR TANK CAR MANUAL.

REV	BY	DATE	DESCRIPTION
C	WEB	11-17-15	ADDED NOTES
B	WEB	2-19-13	PART NUMBER WAS TE4SWF1
A	WEB	2-18-13	RELEASED FOR PRODUCTION

<small>UNLESS OTHERWISE SPECIFIED DIMENSIONAL TOLERANCES</small> FRACTIONAL: $\pm 1/16$ X.XX: $\pm .03$ X.XXX: $\pm .015$ ANGULAR: $\pm 1^\circ$ DEBURR ALL SHARP EDGES. ALL MACHINED SURFACES TO HAVE A 125 RMS FINISH UNLESS NOTED OTHERWISE. <small>THIRD ANGLE PROJECTION</small>	DRAWN BY:	WEB
	CHECKED BY:	CHL
	PROTOTYPE BY:	WEB
	PROTOTYPE DATE:	2/14/2013
	APPROVED FOR PRODUCTION BY:	VD
	PRODUCTION DATE:	2/18/2013

**SALCO PRODUCTS, INC.**

**QUICK CONNECT ADAPTER 4" FLANGED**

MATERIAL: **SEE BOM**

PROJECT #: **130214FR** SHEET #: **1 OF 1** SCALE: **1:1**

DRAWING #: **D35401** PART #: **TE4SFW1**