

NO.	PART NAME	PART#	REQ'D	MATERIAL
1	QUICK CONNECT CAP 2" THREAD ON	TE20S416DLPDC07A	1	416 SS
2	TOP FITTING FLANGE 2"	TE2S75FASH4	1	316L SS

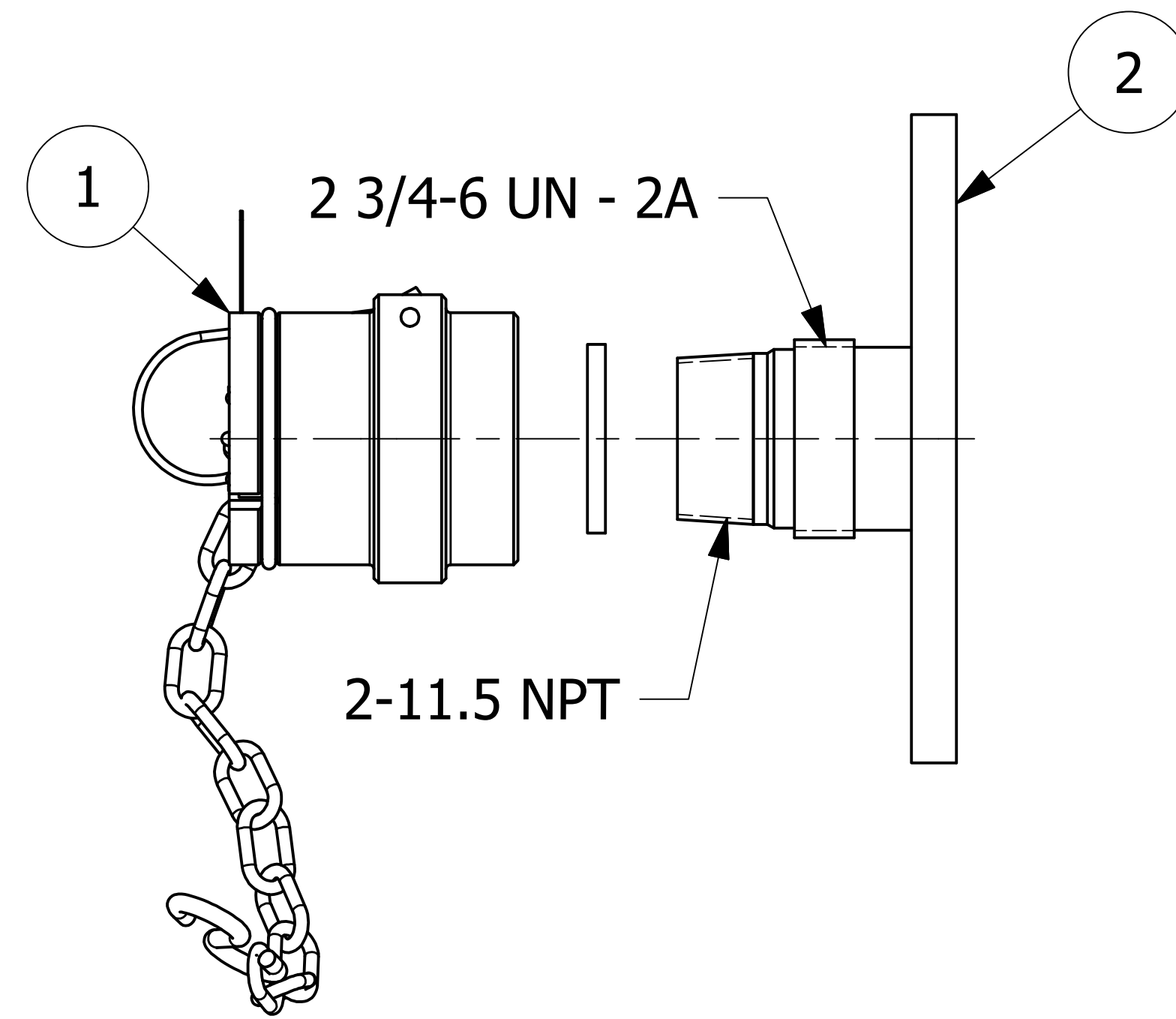
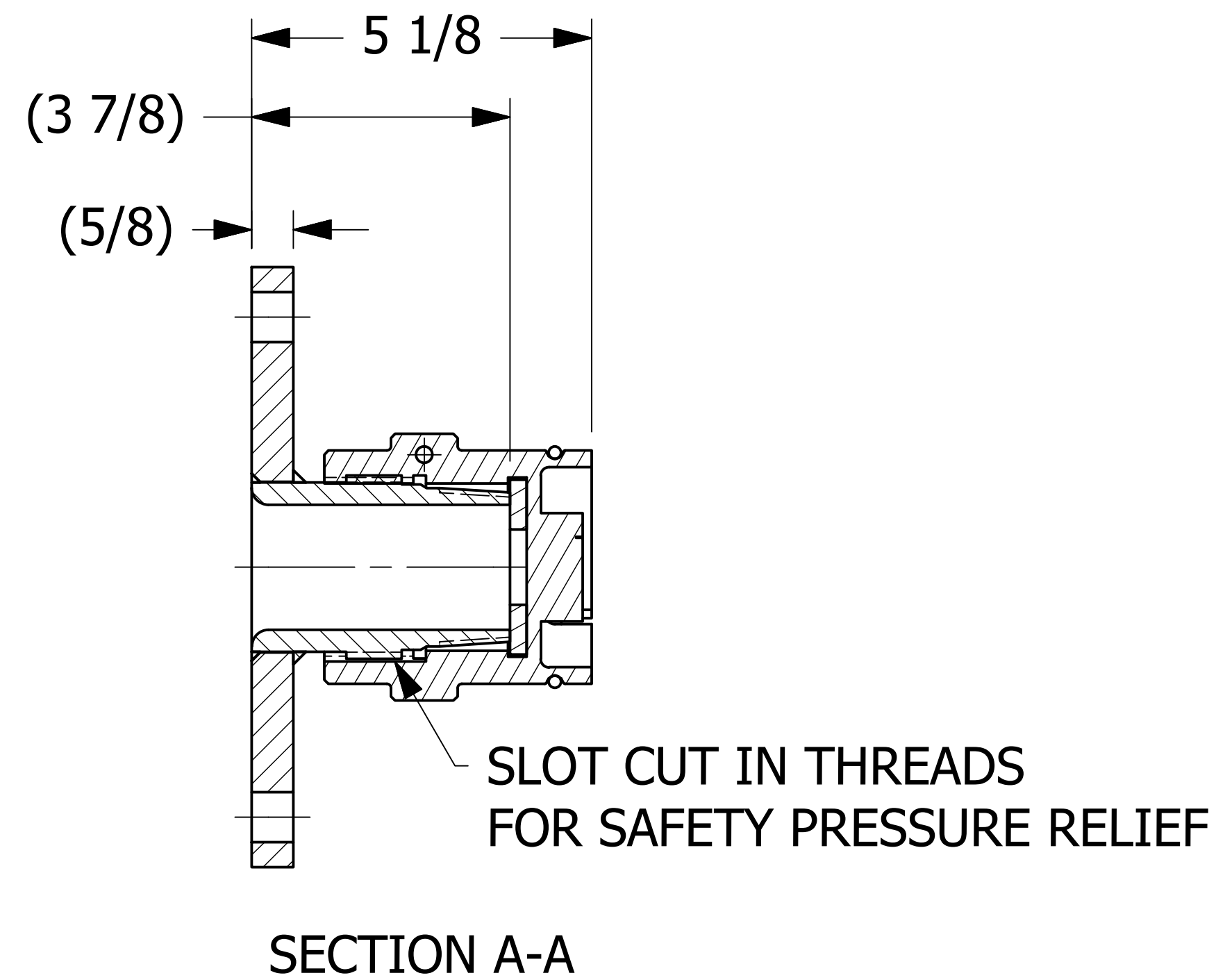
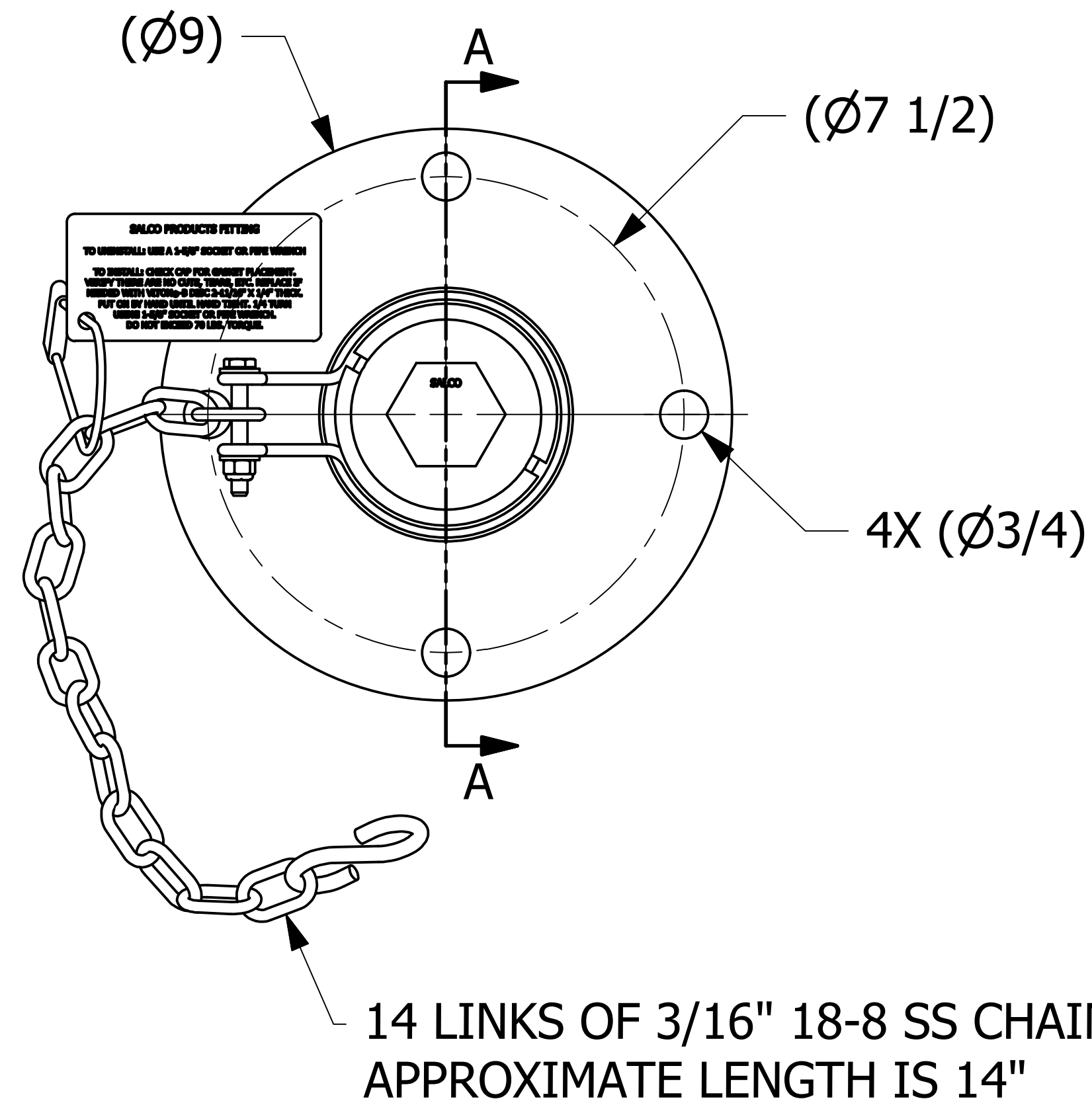

NOTE:  
CAP GASKET MATERIAL IS BLACK VITON B.

C	TAK	1/18/21	REPLACED TE2S75FASH2 W/ TE2S75FASH4; UPDATED TITLE BLOCK & GASKET ID VIEW
B	RJP	8/25/17	UPDATED CAP TO LIPPED DESIGN
A	WEB	9/5/13	RELEASED FOR PRODUCTION
REV	BY	DATE	DESCRIPTION

UNLESS OTHERWISE SPECIFIED DIMENSIONAL TOLERANCES	DRAWN BY:	WEB
FRACTIONAL: ±1/16	CHECKED BY:	CHL
X.XX: ±.03	PROTOTYPE DATE:	9/3/2013
X.XXX: ±.015	APPROVED FOR PRODUCTION BY:	
ANGULAR: ±1°	PRODUCTION DATE:	9/5/2013
DEBURR ALL SHARP EDGES. ALL MACHINED SURFACES TO HAVE A 125 RMS FINISH UNLESS NOTED OTHERWISE.	SIZE:	D
THIRD ANGLE PROJECTION	DRAWING #:	37107

<b>SALCO PRODUCTS, INC.</b>		
PART NAME: <b>TOP FITTING ASSEMBLY 2" FLANGED</b>		
MATERIAL: <b>SEE BOM</b>		
PROJECT #:	130828FR1	SHEET #: 1 OF 1
PART #:		SCALE: 1:2
<b>TE2S416DCS75F07A1</b>		