

NO.	PART NAME	PART#	REQ'D	MATERIAL
1	BLIND FLANGE 3" 150#	HS3150BFP	1	SALCO PE

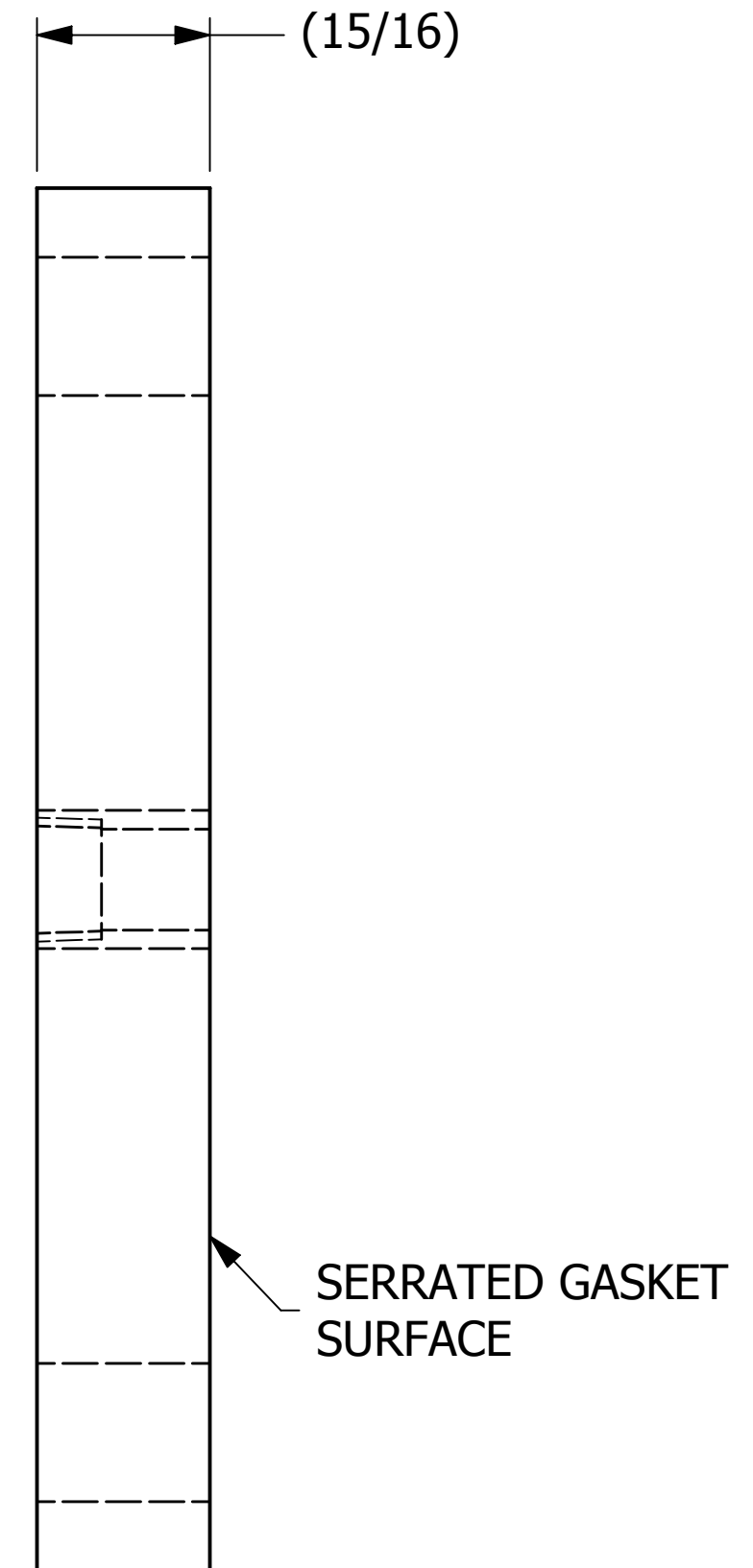
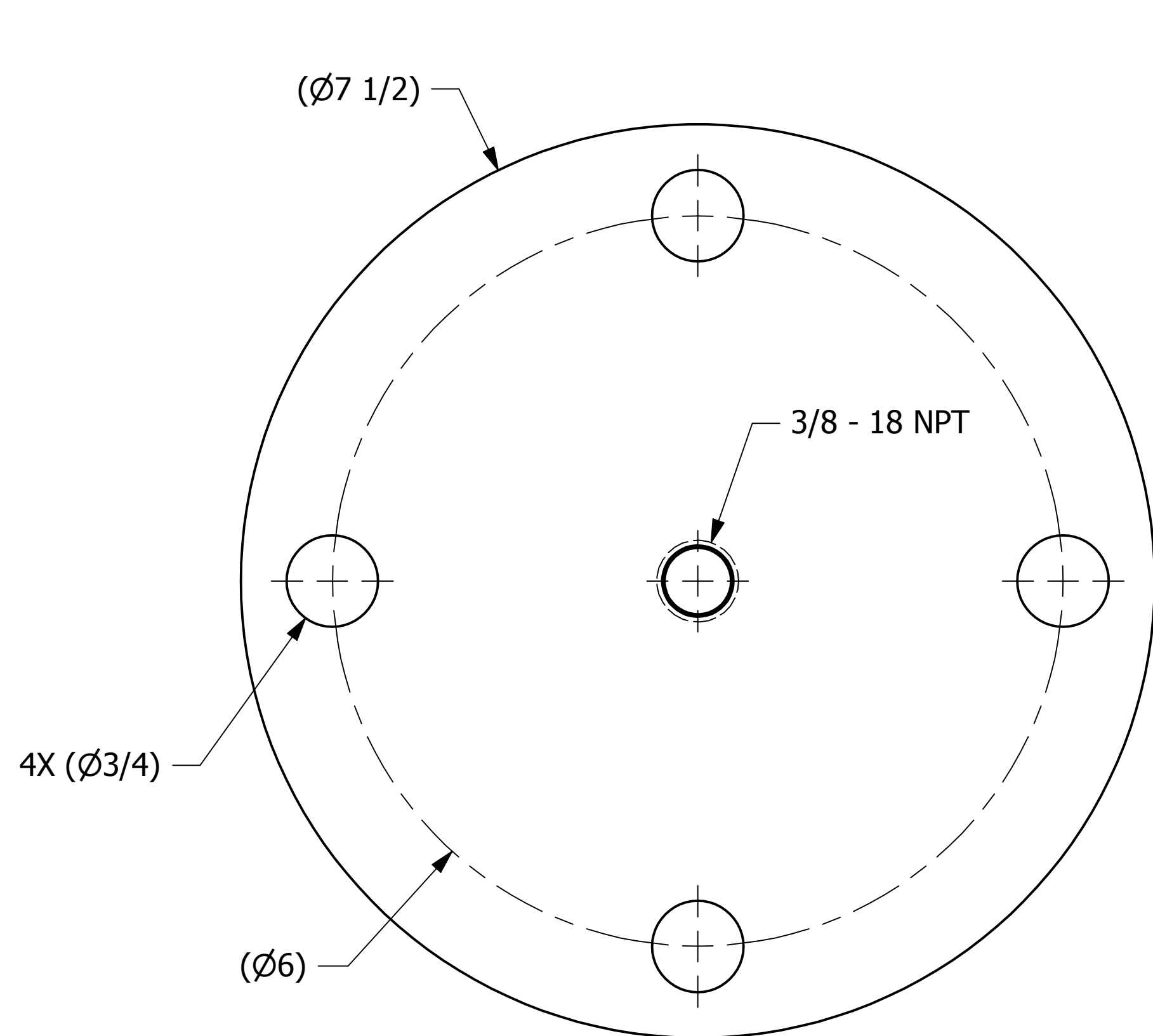

REV	BY	DATE	DESCRIPTION
A	GDS	7-19-11	NEW DRAWING ADDED TO SYSTEM

<small>UNLESS OTHERWISE SPECIFIED DIMENSIONAL TOLERANCES FRACTIONAL: ±1/16 X.XX: ±.03 X.XXX: ±.015 ANGLE: ±1° DEBURR ALL SHARP EDGES. ALL MACHINED SURFACES TO HAVE A 125 RMS FINISH UNLESS NOTED OTHERWISE. THIRD ANGLE PROJECTION</small>	DRAWN BY:	BRG
	CHECKED BY:	WRB
	PROTOTYPE BY:	BRG
	PROTOTYPE DATE:	11/29/2010
	APPROVED FOR PRODUCTION BY:	WRB
	PRODUCTION DATE:	7/19/2011

**SALCO PRODUCTS, INC.**  
*Hazarsolve® Division*

PART NAME:  
**AIR INLET FLANGE 3" 150 LB**

MATERIAL: **SEE BOM**

PROJECT #: **031212AD** SHEET #: **1 OF 1** SCALE: **1:1**

DRAWING #: **C29913** PART #: **HS3150AIFP**

THIS PRINT, PROPERTY OF SALCO PRODUCTS INC, CONTAINS PROPRIETARY INFORMATION AND MUST NOT BE COPIED, REPRODUCED, OR USED DETRIMENTALLY TO OUR INTEREST.