

NO.	PART NAME	PART#	REQ'D	MATERIAL
1	BUTTON HEAD ROD 7/8"X3 1/2"	BHR7835H2C1	1	CS
2	FLAT WASHER 7/8"	WASH78T	2	CS
3	SLOTTED ROUND SCREW 1/4"-20X1 1/2"	SRS25X112CS	1	CS Z/P
4	HEX NUT 1/4"-20	FHN36302	1	CS Z/P

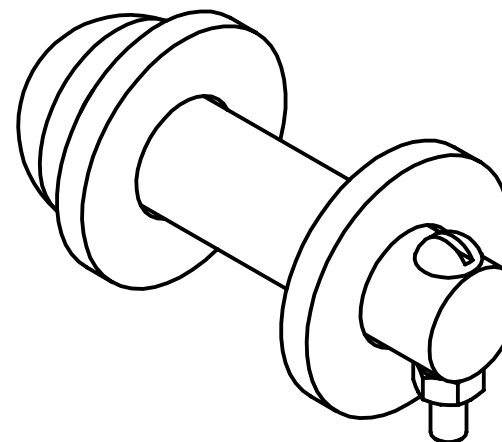
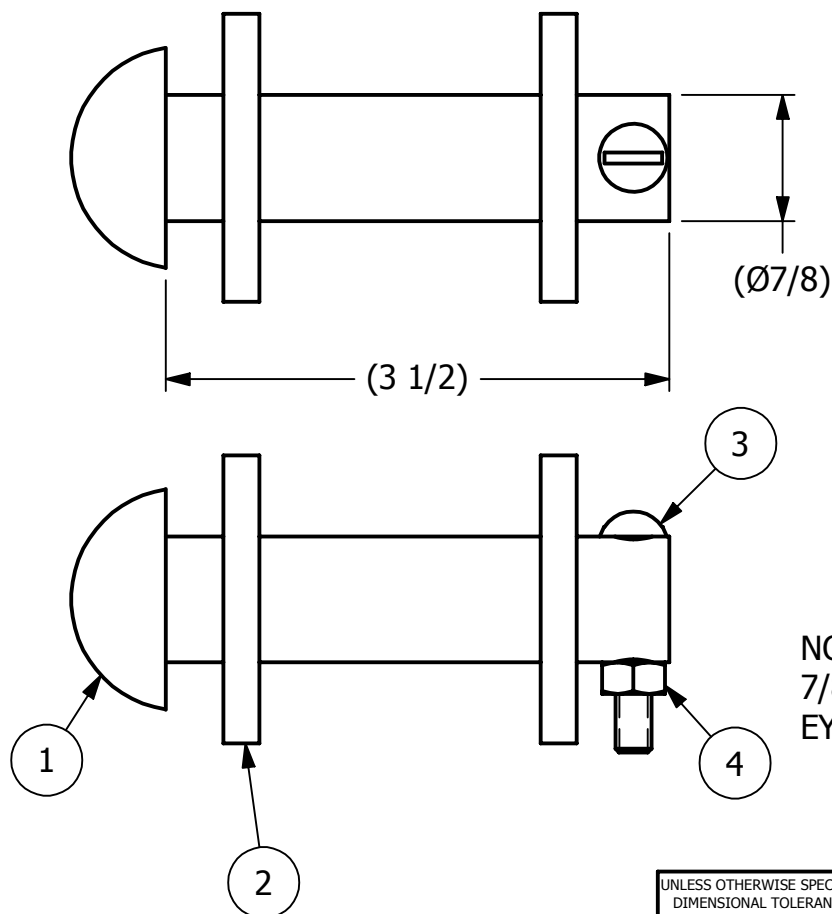

ISOMETRIC VIEW

NOTE:
7/8" BUTTON HEAD ROD WAS MADE TO FIT 7/8" AND 1"
EYEBOLTS.

B	WEB	12-21-16	CHANGED DESCRIPTION FROM BUTTON RIVET TO ROD, UPDATED BOM AND NOTE
A	JRS	7-27-11	DRAWING ADDED TO NETWORK
REV	BY	DATE	DESCRIPTION

UNLESS OTHERWISE SPECIFIED
DIMENSIONAL TOLERANCES
FRACTIONAL: $\pm 1/16$
X.XX: $\pm .03$
X.XXX: $\pm .015$
ANGULAR: $\pm 1^\circ$
DEBURR ALL SHARP EDGES.
ALL MACHINED SURFACES TO
HAVE A 125 RMS FINISH
UNLESS NOTED OTHERWISE.

THIRD ANGLE PROJECTION

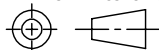

DRAWN BY:	VD
CHECKED BY:	CHL
PROTOTYPE BY:	VD
PROTOTYPE DATE:	7/21/2010
APPROVED FOR PRODUCTION BY:	JRS
PRODUCTION DATE:	7/27/2011



SALCO PRODUCTS, INC.

PART NAME:

BUTTON HEAD ROD 7/8"X3 1/2"

MATERIAL: SEE BOM

PROJECT #: WAG0858

SHEET #: 1 OF 1

SCALE: 3:4

DRAWING #:

A29121

PART #:

BHR7835H2C1A