

NO.	PART NAME	PART#	REQ'D	MATERIAL
1	BUTTON HEAD ROD	BHR34350HC1T	1	CS COATED
2	COTTER PIN 3/16"X2"	CP3162S6	1	316 SS
3	FLAT WASHER 3/4" USS	WASH34S6	2	316 SS

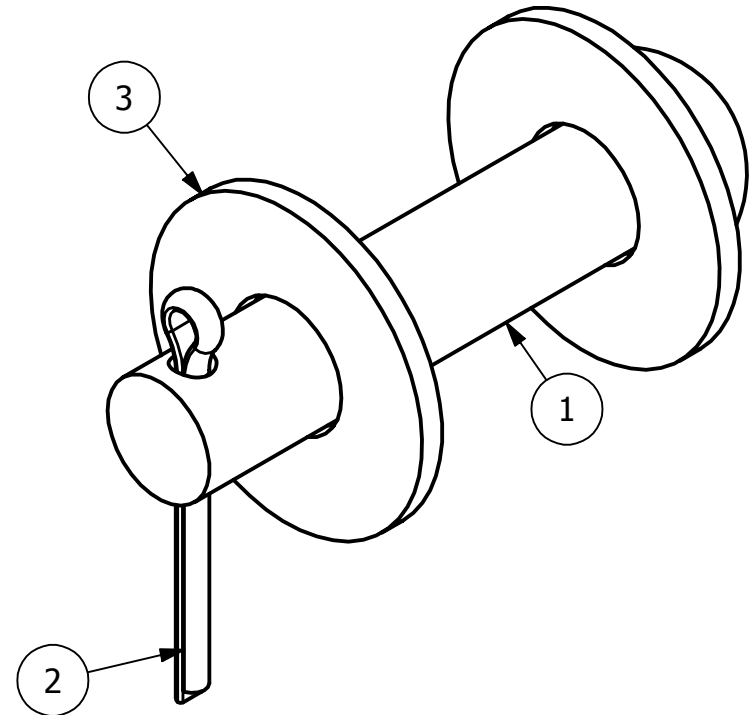
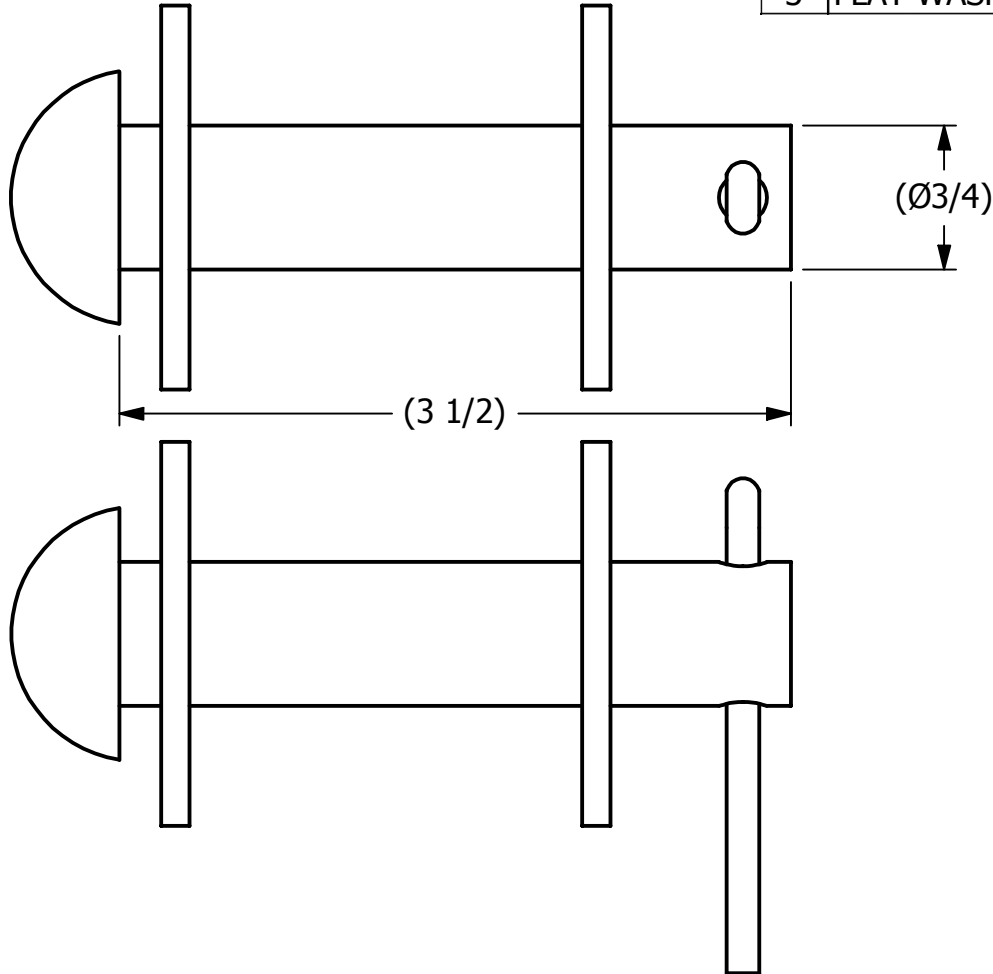

B	WEB	7-17-17	PART DESCRIPTION WAS BUTTON HEAD RIVET ASSEMBLY
A	CHL	9-11-09	NEW PART ADDED TO SYSTEM
REV	BY	DATE	DESCRIPTION

NOTE:
 3/4" BUTTON HEAD ROD WAS MADE TO FIT 7/8" AND 3/4" EYEBOLTS. IT MAY BE USED WITH A 1" EYEBOLTS IF THE CUSTOMER REQUESTS IT BUT IT IS NOT A RECOMMENDATION MADE BY SALCO.

UNLESS OTHERWISE SPECIFIED
 DIMENSIONAL TOLERANCES
 FRACTIONAL: $\pm 1/16$
 X.XX: $\pm .03$
 X.XXX: $\pm .015$
 ANGULAR: $\pm 1^\circ$
 DEBURR ALL SHARP EDGES.
 ALL MACHINED SURFACES TO
 HAVE A 125 RMS FINISH
 UNLESS NOTED OTHERWISE.

THIRD ANGLE PROJECTION

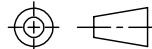

DRAWN BY:	CHL
CHECKED BY:	PJG
PROTOTYPE BY:	CHL
PROTOTYPE DATE:	1/15/2009
APPROVED FOR PRODUCTION BY:	PJG
PRODUCTION DATE:	9/11/2009

SALCO PRODUCTS, INC.		
PART NAME: BUTTON HEAD ROD ASSEMBLY		
MATERIAL: SEE BOM		
PROJECT #:	WAG0641	SHEET #: 1 OF 1
SCALE:	1:1	
DRAWING #:	A26400	PART #:
		BHR3435HC1AT