

NO.	PART NAME	PART#	REQ'D	MATERIAL
1	SHEET 1"	SHT1ACCL	.88 SQ FT	ACRYLIC

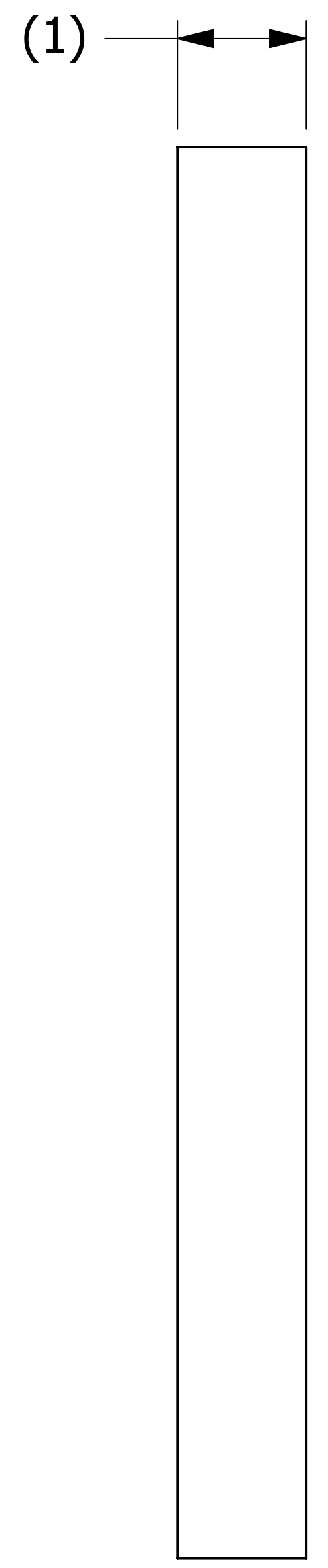
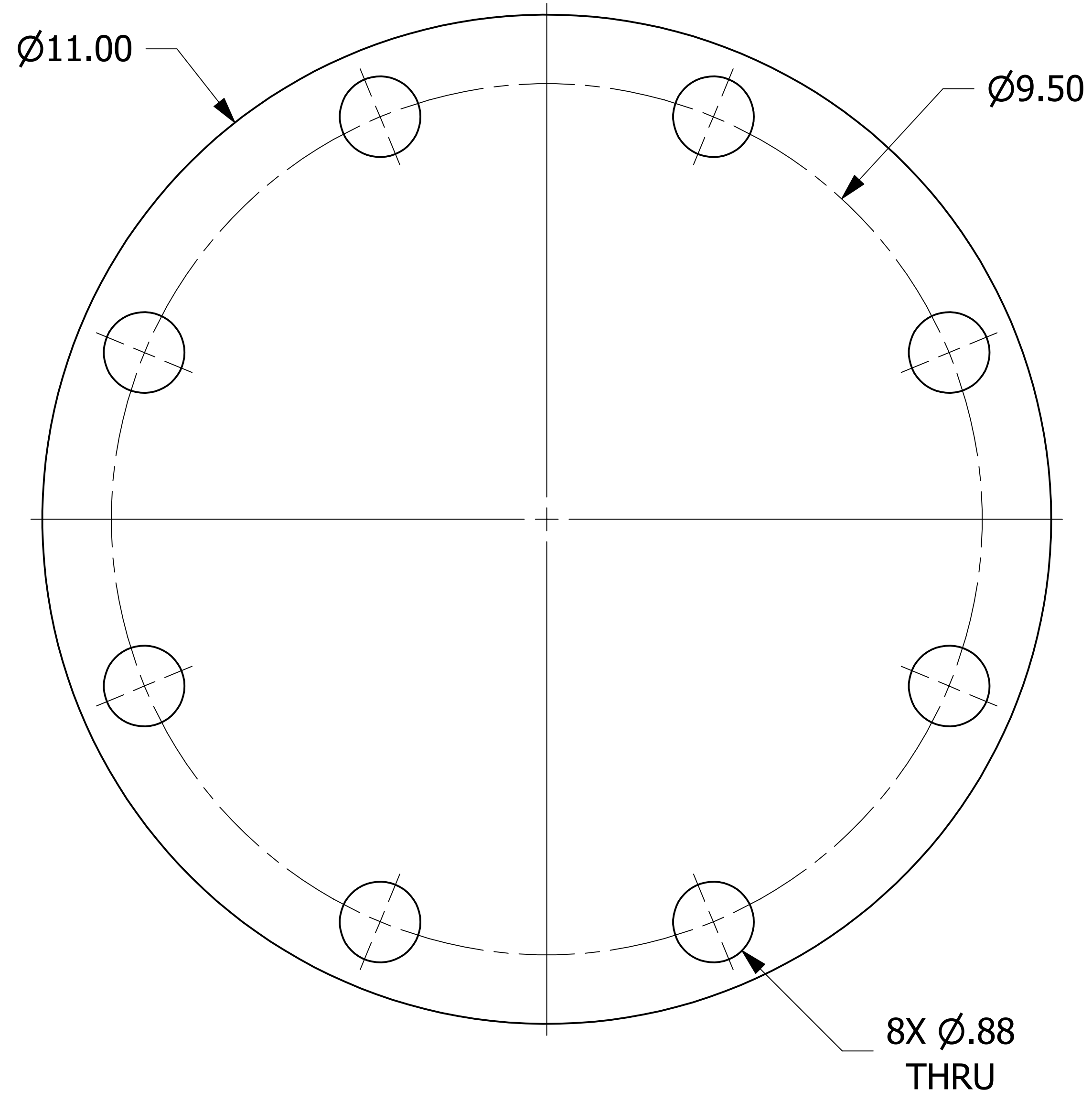

NOTE:
FLANGE FACES ARE POLISHED CLEAR.

REV	BY	DATE	DESCRIPTION
A	JRS	1-26-11	NEW PART ADDED TO SYSTEM

<small>UNLESS OTHERWISE SPECIFIED DIMENSIONAL TOLERANCES</small> FRACTIONAL: ±1/16 X.XX: ±.03 X.XXX: ±.015 ANGULAR: ±1° DEBURR ALL SHARP EDGES. ALL MACHINED SURFACES TO HAVE A 125 RMS FINISH UNLESS NOTED OTHERWISE. <small>THIRD ANGLE PROJECTION</small>	DRAWN BY:	WRB
	CHECKED BY:	PJG
	PROTOTYPE BY:	WRB
	PROTOTYPE DATE:	9/21/2005
	APPROVED FOR PRODUCTION BY:	PJG
PRODUCTION DATE:	4/5/2006	

SALCO PRODUCTS, INC.		
PART NAME: BLIND FLANGE SIGHT GLASS 6"		
MATERIAL: ACRYLIC		
PROJECT #: 031212	SHEET #: 1 OF 1	SCALE: 1:1
DRAWING #: D21041	PART #: HS6BSGFLA	

THIS PRINT, PROPERTY OF SALCO PRODUCTS INC. CONTAINS PROPRIETARY INFORMATION AND MUST NOT BE COPIED, REPRODUCED, OR USED DETRIMENTALLY TO OUR INTEREST.